

## PRODUCT INFORMATION

### DIMENSIONS

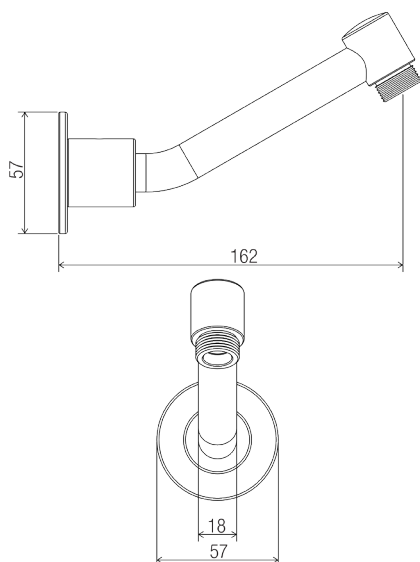

### INDICATIVE IMAGE



### UPSWEPT FIXED ARM

#### Product Code - Finish

- SA 030 C/FF - Chrome

#### Features

- 150 mm upswept fixed shower arm
- Brass construction
- Brass 57 mm wall flange
- Full flow INTERCHANGE® spigot
- ½" BSP female inlet with ½" BSP male threaded outlet
- Chrome plated finish
- OTHER FLOW RATES AVAILABLE

#### Compliance

- Not required for sale

#### Warranty

See Con-Serv warranty policy for full details.

CON-SERV CORPORATION AUSTRALIA PTY. LTD.

17 Glentanna Street, Kedron · Qld. 4031 Australia

Phone: +61 (0)7 3630 5744 · Fax: +61 (0)7 3630 5755 · Email: mail@con-serv.com.au · www.con-serv.com.au